



SIGMA INDUSTRIES

CGF IIC FLAME-PROOF / WEATHER-PROOF [IIC] DOUBLE COMPRESSION CABLE GLANDS:

These indoor and outdoor cable glands are for use with all types of armoured & un-armoured cables, providing environmental seal for inner & outer sheath of cables. The Cable Glands also provides mechanical cable retention and electrical continuity via armour wire termination. A detachable armour cone and anyway universal clamping ring arrangement allows the cable to be easily disconnected from the equipment, for maintenance and change out etc.

| TECHNICAL DATA: | |
|------------------------------------------------------------------------------------------------------------------------------------------------------------------------------------------------------------------------|-------------------------------------------------------------------------------------------------------------------------------------------------------|
| Type: | CGF IIC [Double Compression] |
| Design Specification: | IS / IEC 60079-1: 2014, [FLAME-PROOF GROUP IIC] |
| Threads: | E.T., NPT, METRIC & PG |
| Operating Temperature: | -30°C to + 100°C |
| Protection Class: | IP 66 [IS/IEC 60529:2001 (Reaffirmed 2014)] TESTED BY CIMFR |
| Gland Material: | Electro Nickel Plated Brass [general] Material options: Stainless steel, Mild steel & Aluminum Plating options: Chrome, Tin, Zinc |
| Seal Material: | Neoprene Rubber |
| Accessories [optional]: | Shroud, Earth Tag, Blank plugs Adaptor Reducer, Entry Thread Seal |
| Part Number Details: | |
| 1. Compression Nut 2. Support Ring [PVC] 3. Outer Seal 4. Cover Nut 5. Armour Cone 6. Clamping Ring 7. Inner seal 8. Gland Body 9. Flat Washer 10. Lock Nut [Not applicable for NPT Thread] | |

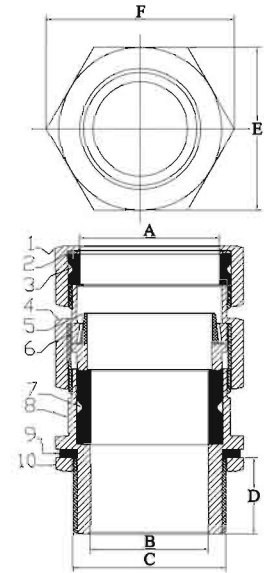

Cable Gland Selection Table: [All dimensions except thread sizes are in M.M.]

Note: Special / customized requirement will also be accepted.

| GLAND SIZE [Cat. No.] | DIA. "A" [Max. - Min.] | DIA. "B" [Max. - Min.] | ENTRY "C" [THREADS] | | | LENGTH "D" [Max.] | FLAT "E" [Max.] | CORNER "F" [Max.] |
|--------------------------|---------------------------|---------------------------|---------------------|-----|----------|----------------------|--------------------|----------------------|
| | | | E.T. | MM | NPT | | | |
| CGF IIC 01SS | 13.00 - 8.50 | 8.50 - 6.50 | 3 / 4" | 16 | 1/2" | 25.00 | 22.00 | 25.40 |
| CGF IIC 01S | 16.50 - 11.50 | 11.00 - 8.00 | 3 / 4" | 20 | 1/2" | 25.00 | 25.00 | 29.00 |
| CGF IIC 01 | 18.00 - 13.00 | 12.00 - 9.00 | 3 / 4" | 20 | 1/2" | 25.00 | 28.00 | 32.00 |
| CGF IIC 01A | 18.00 - 13.00 | 12.00 - 9.00 | 1" | 25 | 3 / 4" | 25.00 | 28.00 | 32.00 |
| CGF IIC 02 | 20.00 - 15.00 | 14.00 - 11.00 | 1" | 25 | 3 / 4" | 25.00 | 31.50 | 36.50 |
| CGF IIC 02A | 20.00 - 15.00 | 14.00 - 11.00 | 3 / 4" | 20 | 1/2" | 25.00 | 31.50 | 36.50 |
| CGF IIC 03 | 23.00 - 17.00 | 17.00 - 14.00 | 1" | 25 | 3 / 4" | 25.00 | 32.00 | 37.00 |
| CGF IIC 04 | 26.00 - 20.00 | 20.00 - 15.00 | 1" | 25 | 3 / 4" | 25.00 | 38.00 | 44.00 |
| CGF IIC 04A | 26.00 - 20.00 | 20.00 - 15.00 | 1.1 / 4" | 32 | 1" | 25.00 | 38.00 | 44.00 |
| CGF IIC 05 | 30.00 - 24.00 | 24.00 - 19.00 | 1.1 / 4" | 32 | 1" | 25.00 | 41.00 | 47.00 |
| CGF IIC 05A | 30.00 - 24.00 | 24.00 - 19.00 | 1.1 / 2" | 40 | 1.1 / 4" | 25.00 | 41.00 | 47.00 |
| CGF IIC 06 | 33.00 - 25.00 | 27.00 - 23.00 | 1.1 / 2" | 40 | 1.1 / 4" | 25.00 | 46.00 | 52.50 |
| CGF IIC 06A | 33.00 - 25.00 | 27.00 - 23.00 | 1.1 / 4" | 32 | 1" | 25.00 | 46.00 | 52.50 |
| CGF IIC 07 | 37.00 - 30.00 | 30.00 - 25.00 | 1.1 / 2" | 40 | 1.1 / 4" | 25.00 | 52.00 | 59.50 |
| CGF IIC 08 | 41.00 - 34.00 | 35.00 - 30.00 | 2" | 50 | 1.1 / 2" | 25.00 | 56.00 | 64.00 |
| CGF IIC 09 | 46.00 - 38.00 | 40.00 - 33.00 | 2" | 50 | 1.1 / 2" | 25.00 | 59.00 | 67.00 |
| CGF IIC 010 | 52.00 - 43.00 | 44.00 - 38.00 | 2" | 50 | 1.1 / 2" | 25.00 | 67.50 | 77.00 |
| CGF IIC 010A | 52.00 - 43.00 | 44.00 - 38.00 | 2.1 / 2" | 63 | 2" | 25.00 | 67.50 | 77.00 |
| CGF IIC 011S | 56.00 - 46.00 | 50.00 - 45.00 | 2.1 / 2" | 63 | 2" | 25.00 | 74.00 | 85.50 |
| CGF IIC 011 | 60.00 - 50.00 | 54.00 - 47.00 | 2.1 / 2" | 63 | 2" | 25.00 | 80.00 | 92.00 |
| CGF IIC 012 | 67.00 - 58.00 | 60.00 - 53.00 | 3" | 75 | 2.1 / 2" | 25.00 | 85.00 | 98.00 |
| CGF IIC 013A | 72.00 - 63.00 | 66.00 - 60.00 | 3" | 75 | 2.1 / 2" | 25.00 | 97.00 | 112.00 |
| CGF IIC 013 | 78.00 - 68.00 | 72.00 - 64.00 | 3.1 / 4" | 80 | 3" | 25.00 | 99.00 | 114.00 |
| CGF IIC 014 | 84.00 - 72.00 | 78.00 - 70.00 | 3.1 / 2" | 90 | 3" | 25.00 | 108.00 | 125.00 |
| CGF IIC 015 | 94.00 - 84.00 | 88.00 - 78.00 | 4" | 100 | 3.1 / 2" | 25.00 | 117.00 | 135.00 |
| CGF IIC 016 | 105.00 - 94.00 | 98.00 - 88.00 | 4.1 / 2" | 110 | 4" | 25.00 | 130.00 | 150.00 |



CIMFR Approval No.
IN/CIMFR/TR21/H320
IP-66

PESO Approval No.
A/P/HQ/GJ/104/5992
[P529100/1]



AVAILABLE IN
S.S. & ALUMINIUM
ON REQUEST

*Dimensions are subject to be changed without any prior notice.