

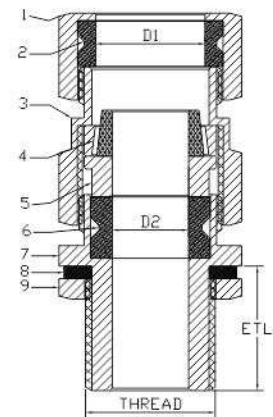

CGS DOUBLE COMPRESSION CABLE GLANDS:

These indoor and outdoor cable glands are for use with all types of armoured & un-armoured cables, providing environmental seal for inner & outer sheath of cables. The Cable Glands also provides mechanical cable retention and electrical continuity via armour wire termination. A detachable armour cone and anyway universal clamping ring arrangement allows the cable to be easily disconnected from the equipment, for maintenance and change out etc.

TECHNICAL DATA:	
Type:	DOUBLE COMPRESSION
Design Specification:	IEC 60529 [WEATHER-PROOF]
Threads:	E.T., NPT & METRIC
Operating Temperature:	-30°C to + 100°C
Protection Class:	IP 66 (TESTED BY NATIONAL TEST HOUSE)
Gland Material:	Electro Nickel Plated Brass (general) Material options: Stainless steel, Mild steel & Aluminum Plating options: Chrome, Tin, Zinc
Seal Material:	Natural Rubber
Accessories (optional):	Shroud, Earth Tag, Blank plugs, Adapter / Reducer, Entry Thread Seal
Part Number Details:	
1. Compression Nut 2. Outer Seal 3. Cover Nut 4. Clamping Ring 5. Armour Cone 6. Inner seal 7. Gland Body 8. Flat Washer 9. Lock Nut [Not applicable for NPT Thread]	

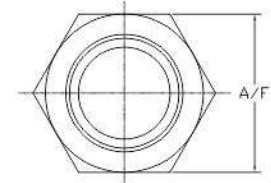

Cable Gland Selection Table: (All dimensions except thread sizes are in M.M.)

Note: *Special / customized requirement will also be accepted.*

GLAND SIZE	D1	D2	THREAD	ETL	A/F
3/8" (10 mm)	9.50 - 6.00	8.00 - 5.00	1/2" ET	25.00	17.75
1/2" (12 mm)	15.00 - 9.50	12.00 - 08.00	5/8" ET	25.00	22.00
5/8" (16 mm)	16.00 - 10.50	12.00 - 08.00	3/4" ET	25.00	23.00
3/4" (19 mm)	17.50 - 10.50	14.00 - 09.50	3/4" ET	25.00	24.00
7/8" (22 mm)	19.00 - 11.00	14.00 - 09.50	3/4" ET	25.00	25.50
1" (25 mm)	23.00 - 17.00	18.50 - 14.50	1" ET	25.00	31.50
1.1/8" (28 mm)	26.00 - 21.00	21.50 - 17.00	1.1/8" ET	25.00	34.50
1.1/4" (32 mm)	31.00 - 24.50	27.00 - 20.00	1.1/4" ET	25.00	41.00
1.3/8" (35 mm)	35.00 - 28.00	29.00 - 21.00	1.3/8" ET	25.00	45.50
1.1/2" (38 mm)	38.00 - 34.00	32.00 - 26.50	1.1/2" ET	25.00	47.50
1.3/4" (45 mm)	46.00 - 40.00	38.00 - 30.00	1.3/4" ET	25.00	56.50
2" (50 mm)	49.00 - 42.00	44.00 - 35.00	2" ET	25.00	61.00
2.1/4" (57 mm)	57.00 - 48.00	48.00 - 40.00	2.1/4" ET	25.00	67.00
2.1/2" (63 mm)	63.00 - 53.00	56.00 - 44.00	2.1/2" ET	25.00	74.50
2.3/4" (70 mm)	68.00 - 58.00	63.00 - 54.00	2.3/4" ET	25.00	82.50
3" (75 mm)	76.00 - 70.00	68.00 - 60.00	3" ET	25.00	92.00
3.1/4" (82 mm)	78.00 - 72.00	70.00 - 64.00	3.1/4" ET	25.00	93.00
3.1/2" (88 mm)	85.00 - 76.00	77.00 - 67.00	3.1/2" ET	25.00	102.00
4" (100 mm)	96.00 - 87.00	86.00 - 75.00	4" ET	25.00	115.00



BS:6121-1-2005
NTH[WR]EL[C]/2019/
000483A
IP-66

*Dimensions are subject to be changed without any prior notice.